

## 1. Accessory

- 1.1 M3 x 4 screws x 2 for securing the device
- 1.2 Quick Installation Guide

## 2. Installation

- 1. Secure the adapter to the media processor with screws and connect the DC power and USB

### ■ LC100/ LC100N

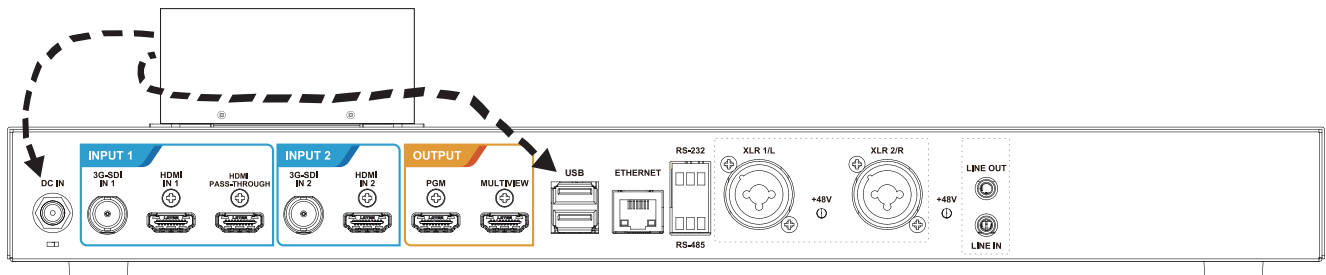

### ■ LC200

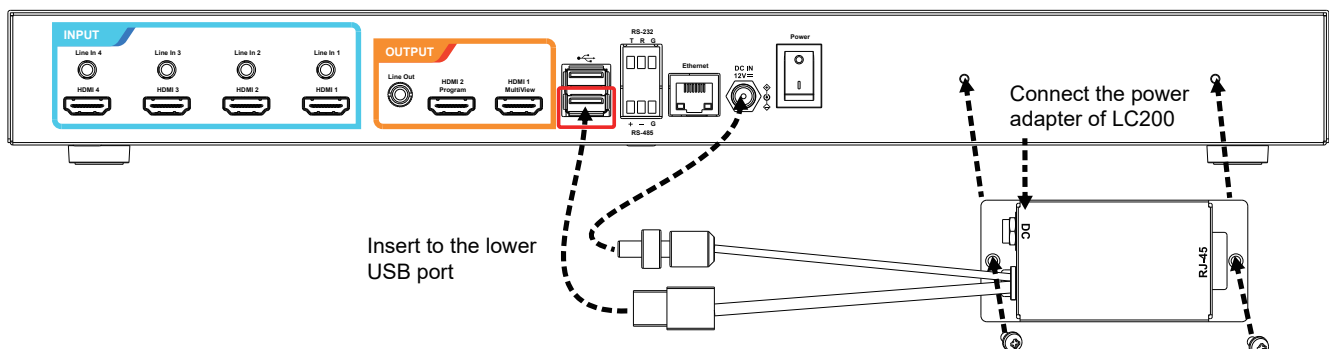

- 2. Use the CAT6 network cable for connection (the length shall not exceed 30 meters)

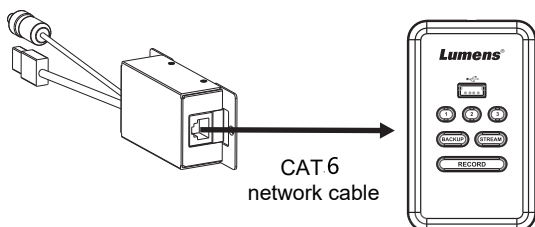

- 3. Pass a cable tie through the mounting hole to secure the network cable onto the LC-RC01 control box

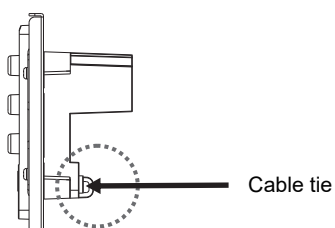

- 4. Install the control box on the wall

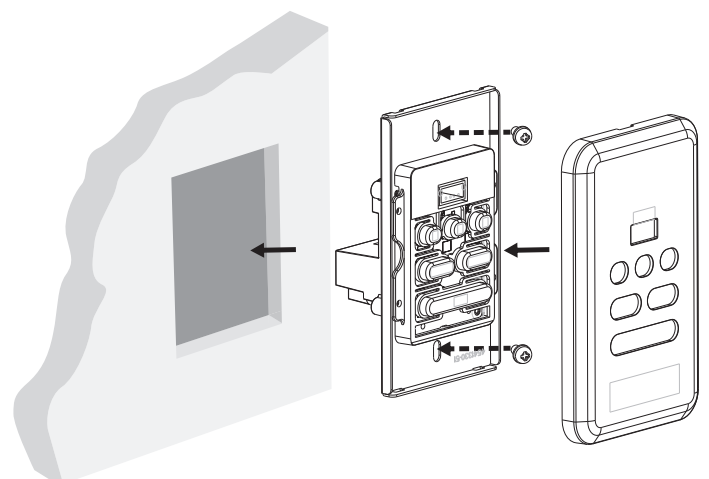

## 3. Size

\*In 1:1 scale

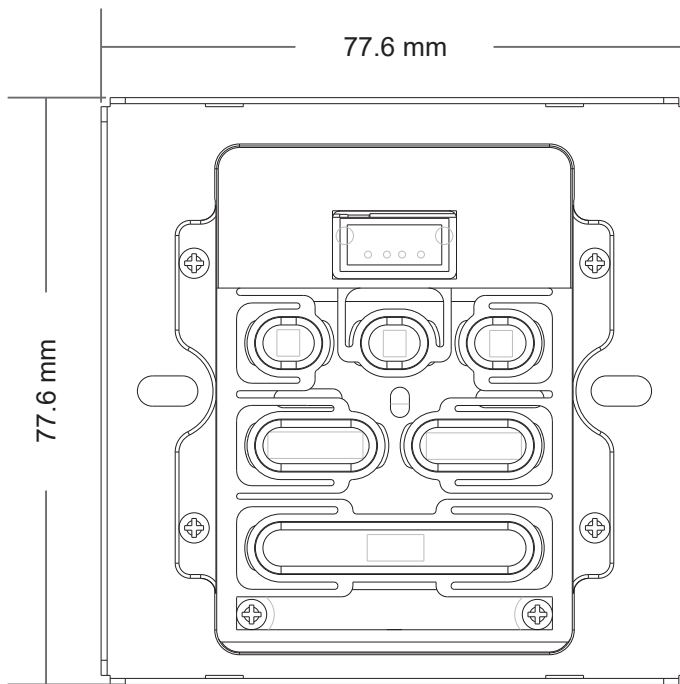

**LC-RC01E**  
EU regulations

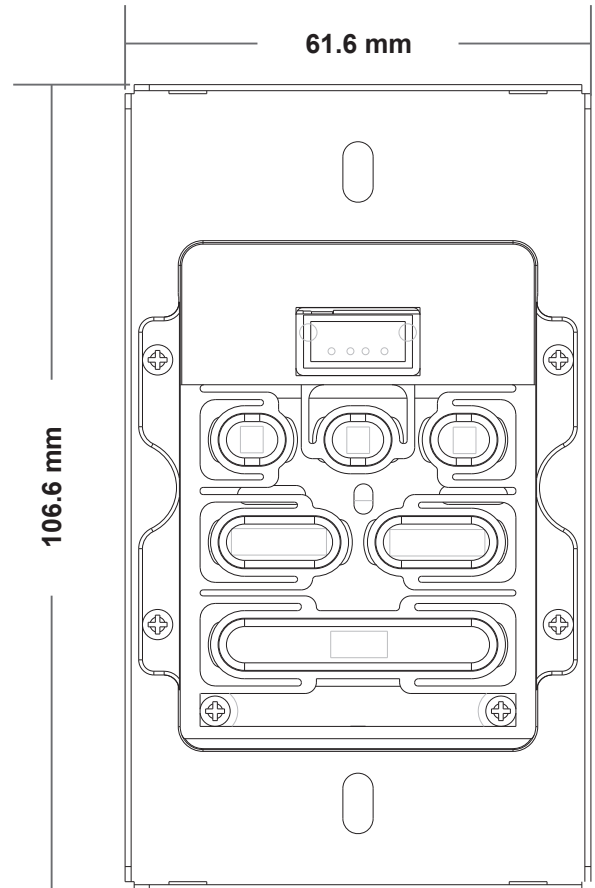

**LC-RC01U**  
North America regulations

## 4. Interface Description

\* LC-RC01 adapter

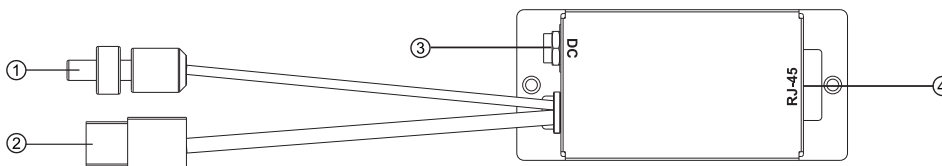

\*LC-RC01 control box  
Front View

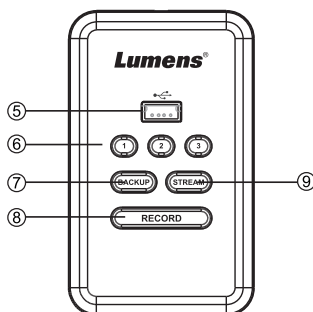

Bottom

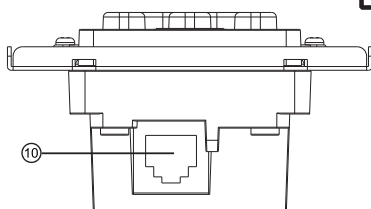

NO.	ITEM	Function Descriptions
1.	DC power output connector	Connect to the media processor device body
2.	USB control connector	Connect to the media processor USB port
3.	DC power input interface	Connect the power cord originally connected to media processor to this power input port
4.	RJ-45 network cable port	Connect the control box
5.	USB 2.0 port	Is available for inserting the USB flash disk
6.	1_2_3	Switch the Macro setting 1~3 to change the scene and camera preset position
7.	BACKUP	Press the button once to start the backup; press the button again to stop the backup (back up the last video directory to the USB flash disk)
8.	RECORD	Press the button once to start recording; press the button again to stop recording
9.	STREAM	Press the button once to start streaming; press the button again to stop streaming
10.	RJ-45 network cable port	Connect to RJ45 of the adapter

\* Please visit YouTube [My Lumens] channel to watch the related videos for instructions

